

Indesit Company S.p.A.
Viale Aristide Merloni, 47
60044 Fabriano (AN)
www.hotpoint-ariston.it

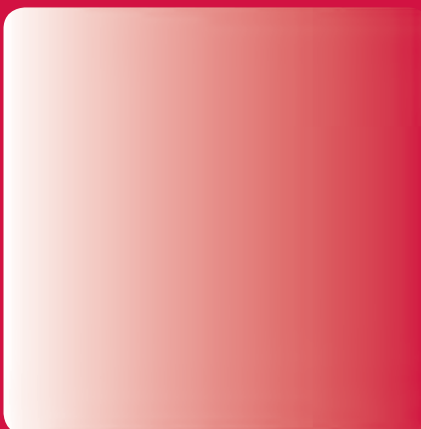

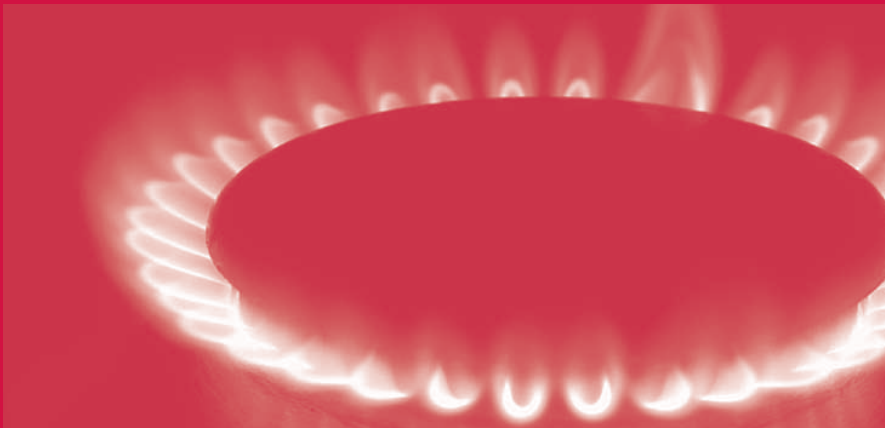

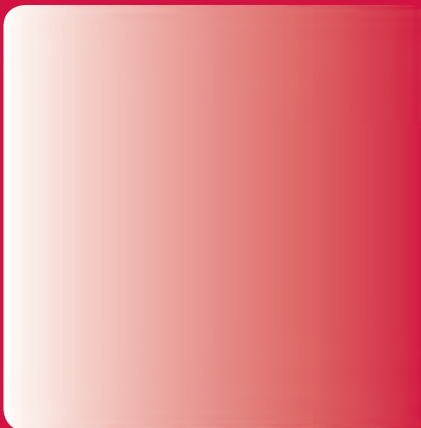

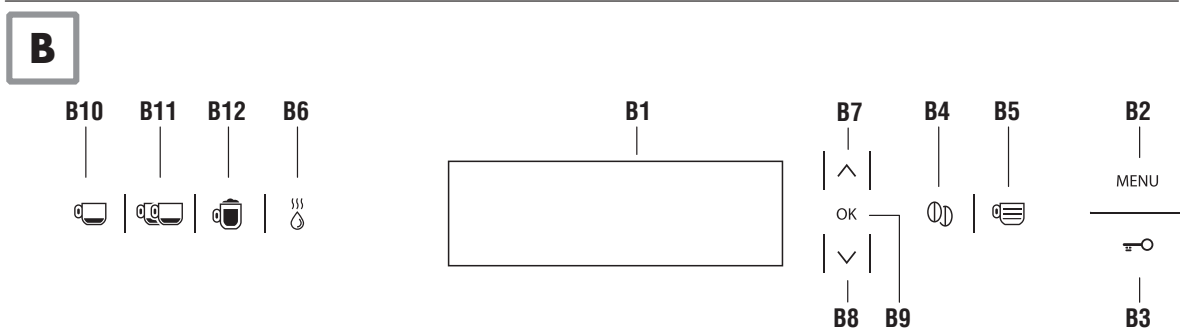
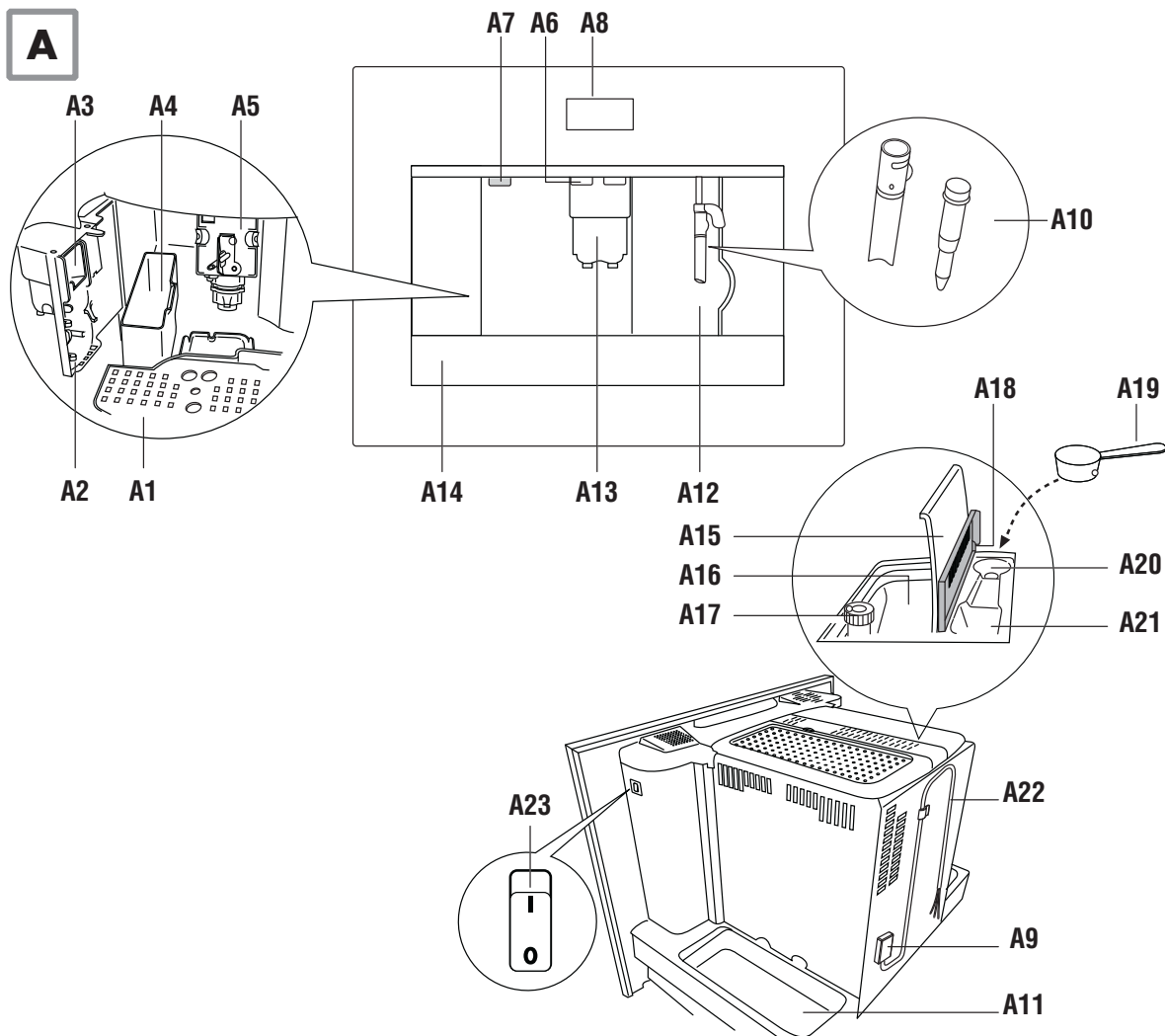
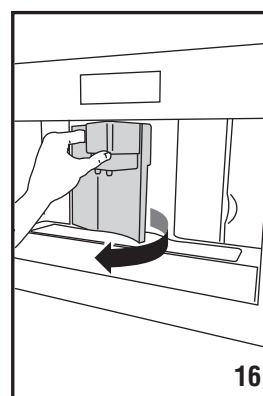
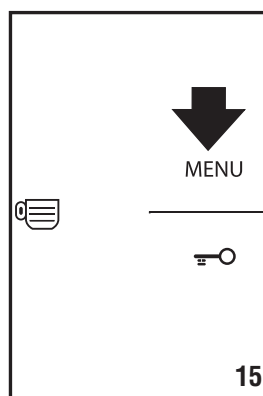
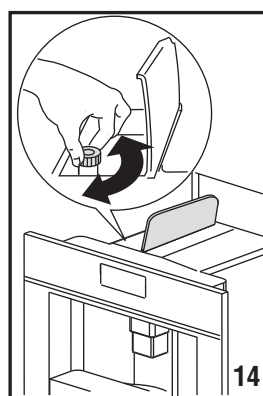
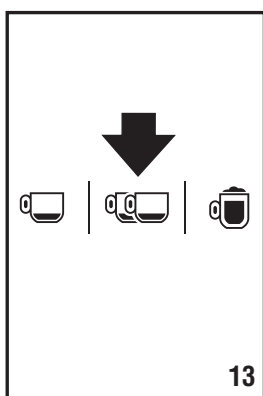
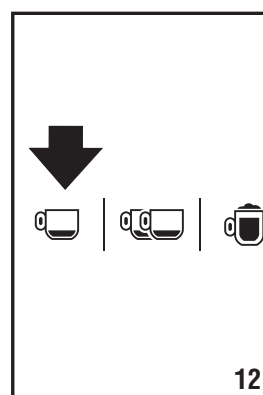
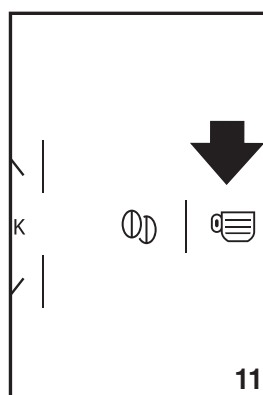
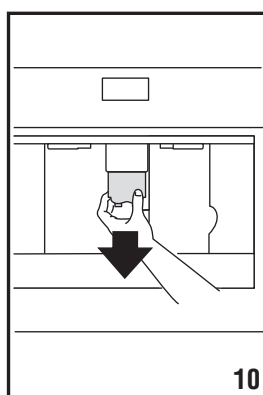
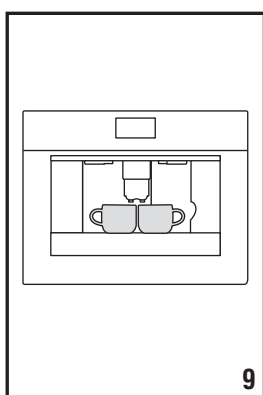
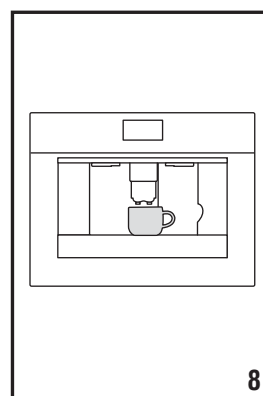
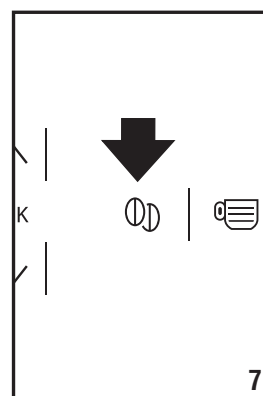
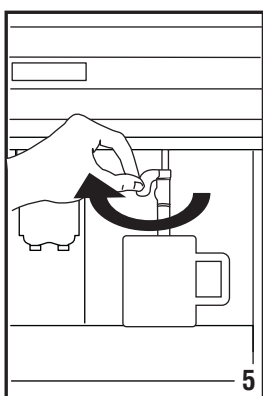
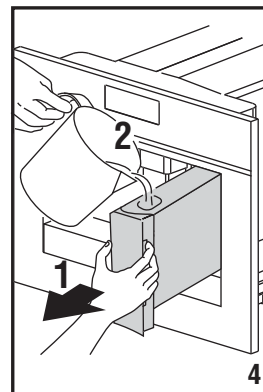
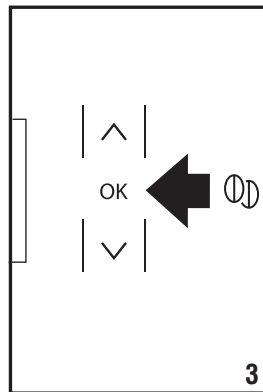
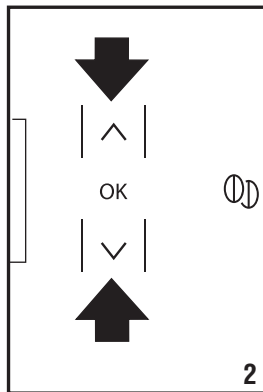
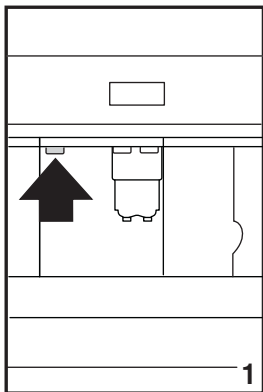

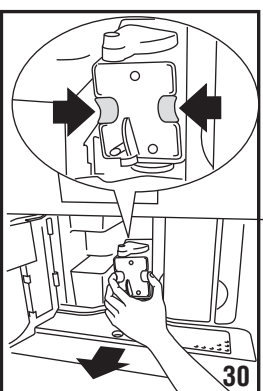
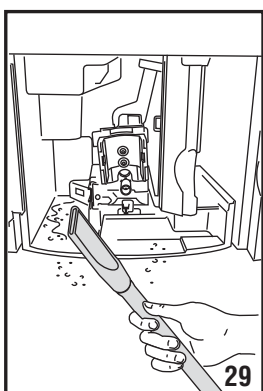
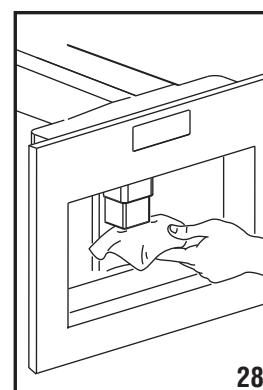
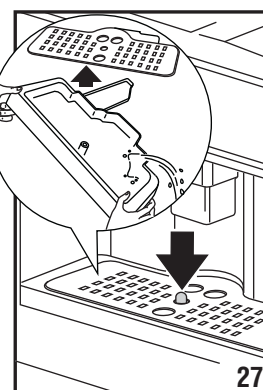
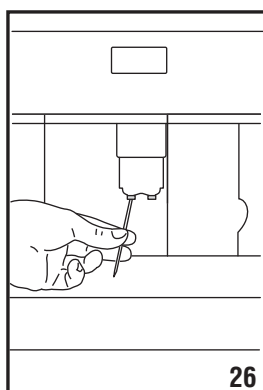
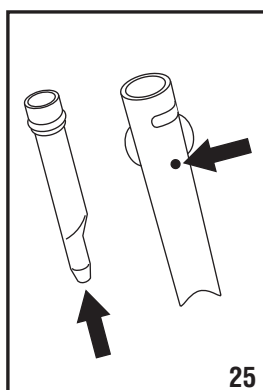
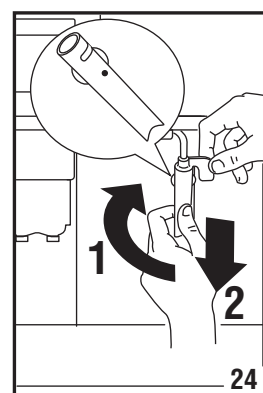
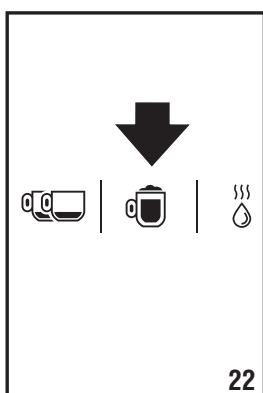
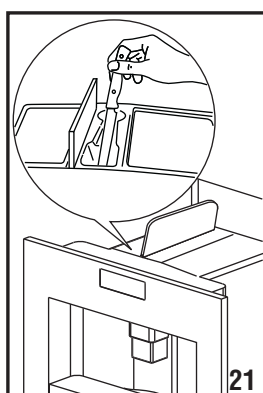
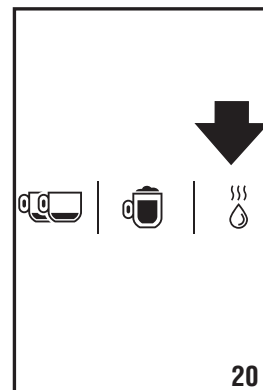
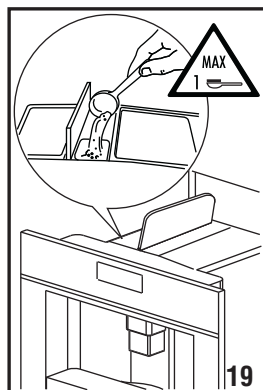
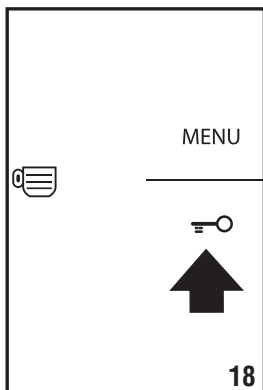
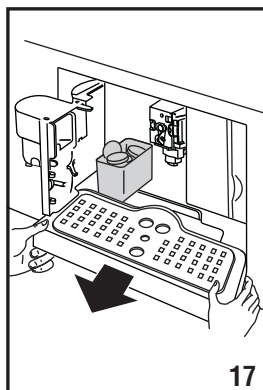

Instructions

COFFEE AND CAPPUCCINO MAKER

GB

FR

Français

GB

English

IT

Italiano

DE

Deutsch

NL

Nederlands

ES

Español

PT

Português

GR

Ελληνικά

RU

Русский

IL

עברית

MCKA103X



ARISTON

CONTENTS

INTRODUCTION	7
Symbols used in these instructions	7
Letters in brackets	7
Troubleshooting and repairs	7
SAFETY	7
Avvertenze fondamentali per la sicurezza	7
Designated use	7
Instructions	7
Child safety	8
DESCRIPTION	8
Description of the appliance	8
Description of the control panel	8
PRELIMINARY CHECKS	8
Controls after transport	8
Installing the appliance	8
Connecting the appliance	8
DISPOSAL	8
BUILT-IN INSTALLATION	9
USING THE APPLIANCE FOR THE FIRST TIME	11
TURNING ON AND HEATING UP	11
MAKING COFFEE USING COFFEE BEANS	11
CHANGING THE QUANTITY OF COFFEE IN THE CUP	12
ADJUSTING THE COFFEE MILL	12
MAKING ESPRESSO COFFEE WITH PRE-GROUND COFFEE (INSTEAD OF BEANS)	12
DELIVERING HOT WATER	12
MAKING CAPPUCCINO (USING THE STEAM FUNCTION)	13
CLEANING	13
Cleaning the coffee maker	13
Cleaning the grounds container	13
Cleaning the drip tray	13
Cleaning the water tank	13
Cleaning the spouts	13
Cleaning the pre-ground coffee funnel	13
Cleaning the inside of the coffee maker	14
Cleaning the brewing unit	14
CHANGING AND SETTING MENU PARAMETERS	14
Rinsing	14
Setting the clock	14
Setting the language	15
Setting auto-start time	15
Descale	15
Changing coffee temperature	15
Changing the length of time the appliance remains on	15
Setting water hardness	15
Resetting default values (reset)	16
Statistics	16

Buzzer	16
TURNING THE APPLIANCE OFF	16
TECHNICAL SPECIFICATION	16
DISPLAYED MESSAGES	17
TROUBLESHOOTING	18

INTRODUCTION

Symbols used in these instructions

Important warnings are identified by these symbols. Failure to observe the instructions could result in electric shock, serious injury, burns, fire or damage to the appliance.



Danger!

Failure to observe the warning could result in possibly life threatening injury from electric shock.



Important!

Failure to observe the warning could result in injury or damage to the appliance.



Danger of burns!

Failure to observe the warning could result in scalds or burns.



N.B.!

Important information for the user

Letters in brackets

The letters in brackets refer to the legend in the Description of the Appliance on page 3.

Troubleshooting and repairs

In the event of problems, follow the information given in the sections "Displayed messages" and "Troubleshooting".

If this does not resolve the problem, you should consult Customer Services.

For repairs, contact Customer Services only.

SAFETY

Fundamental safety warnings



Important! This is an household appliance only.

It is not intended to be used in:

- staff kitchen areas in shops, offices and other working environments;
- farm houses;
- by clients in hotels, motels and other residential type environments;
- bed and breakfast type environments.



Danger! This is an electrical appliance, it is therefore important to respect the following safety warnings:

- Never touch the appliance with damp hands.
- Never touch the plug with damp hands.

- Make sure the socket used is freely accessible at all times, enabling the appliance to be unplugged when necessary.
- If the appliance is faulty, do not attempt to repair. Turn it off using the main switch (A23), unplug from the mains socket and contact Customer Services.



Important! Keep all packaging (plastic bags, polystyrene foam) away from children.



Important! The appliance is not intended for use by persons (including children) with reduced physical, sensory or mental capabilities, or lack of experience and knowledge, unless they have been given supervision or instruction concerning use of the appliance by a person responsible for their safety. Children must be supervised to ensure they do not play with the appliance.



Danger of burns! This appliance produces hot water and steam may form while it is in operation.

Avoid contact with splashes of water or hot steam.

Use knobs and handles.



Important! Do not grasp the coffee maker when it is out of the cabinet. Do not rest recipients containing liquids or inflammable or corrosive materials on top of the appliance. Place the accessories required to make the coffee (the measure for example) in the special holder. Do not rest large objects which could obstruct movement or unstable objects on the appliance.



Important! Do not use the appliance when extracted. Make sure the appliance is inactive before extracting it. The only exception is adjusting the coffee mill which must be done with the machine out (see the section "Adjusting the coffee mill").



N.B.! Use original or manufacturer recommended accessories and spare parts only.

Designated use

This appliance is designed and made to prepare coffee and heat drinks.

All other use is considered improper.

This appliance is not suitable for commercial use.

The manufacturer is not liable for damage deriving from improper use of the appliance.

This appliance can be installed over a built-in oven if the latter is fitted with a cooling fan at the rear (maximum power: 3 kW).

Instructions

Read these instructions carefully before using the appliance.

- Keep these instructions
- Failure to respect these instructions may result in burns or damage to the appliance.

The manufacturer is not liable for damage deriving from failure to respect these instructions.



N.B.! The appliance has a cooling fan. This comes on whenever coffee, steam or hot water is delivered. After several minutes, the fan goes off automatically.

Child safety

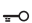
To lock the control panel, press the  icon (B3) then the OK icon (B9).

To unlock the control panel, press any icon, then within 5 seconds, press the OK icon (B9).

DESCRIPTION

Description of the appliance

(page 3 - A)







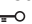

- A1. Cup tray
- A2. Service door
- A3. Coffee guide
- A4. Grounds container
- A5. Brewing unit
- A6. Cup tray lights
- A7. On/OFF/stand-by button
- A8. Control panel
- A9. Terminal board
- A10. Cappuccino maker (removable)
- A11. Tray
- A12. Water tank
- A13. Coffee spout (adjustable height)
- A14. Drip tray
- A15. Bean container lid
- A16. Bean container
- A17. Grinding adjustment knob
- A18. Pre-ground coffee funnel door
- A19. Measure
- A20. Compartment for measure
- A21. Pre-ground coffee funnel
- A22. Power cable
- A23. Main switch

Description of the control panel

(page 3 - B)



N.B.! A light touch is enough to activate the icon.

- B1. Display: guides the user in using the appliance.
- B2. MENU icon to activate or deactivate menu parameter setting mode
- B3.  child safety icon, to lock the control panel
- B4.  icon to select the coffee taste
- B5.  icon to select the type of coffee (espresso, small cup, medium cup, large cup, mug)
- B6.  icon to deliver hot water
- B7-B8.   icons to scroll forwards or backwards through the menu items
- B9. OK icon to confirm the selected item
- B10.  icon to deliver a cup of coffee
- B11.  icon to deliver two cups of coffee
- B12.  icon to deliver steam

PRELIMINARY CHECKS

Controls after transport

After removing the packaging, make sure the product is complete and undamaged and that all accessories are present.

Do not use the appliance if it is visibly damaged.

Contact Customer Services.

Installing the appliance



Important!

- Installation must be performed by a qualified professional in compliance with legislation in force in the country of installation (see Built-in installation).
- The packing elements (plastic bags, polystyrene foam, etc.) should be kept out of reach of children.
- Do not install the appliance in rooms where the temperature may drop to 0°C or lower.
- Customise the water hardness as soon as possible following the instructions in the "Setting water hardness" section.

Connecting the appliance



Danger!

Check that the mains power supply voltage corresponds to the value indicated on the rating plate on the bottom of the appliance.

Connect the appliance to an efficiently earthed and correctly installed socket with a minimum current rating of 10A only.

If the power socket does not match the plug on the appliance, have the socket replaced with a suitable type by a qualified professional.

To comply with safety directives, an omnipolar switch with a minimum contact distance of 3 mm must be installed.

Do not use multiple sockets or extensions.



Important!

Safety cutout devices must be included in the mains power supply in compliance with the installation regulations in the country concerned.

DISPOSAL



Electrical appliances must not be disposed of as household waste.

Appliances with this symbol are covered by European Directive 2002/96/EC.

All unused electric and electronic appliances must be disposed of separately from household waste by taking them to state authorised special centres.

Disposing of the unused appliance correctly avoids damage to the environment and a risk to health.

For more information on disposing of the unused appliance, contact the local administration, the waste disposal department or the shop where the appliance was bought.

BUILT-IN INSTALLATION

Verify the minimum measurements required for correct installation of the appliance.

The coffee maker must be installed in a column and the column must be firmly fixed to the wall with commercially available brackets.

Important:

- Important: all installation or maintenance operations must be performed with the appliance disconnected from the mains electricity supply.
- Kitchen furniture in direct contact with the appliance must be heat resistant (65°C min).
- To guarantee correct ventilation, leave a gap at the bottom of the cabinet (see measurements in figure).

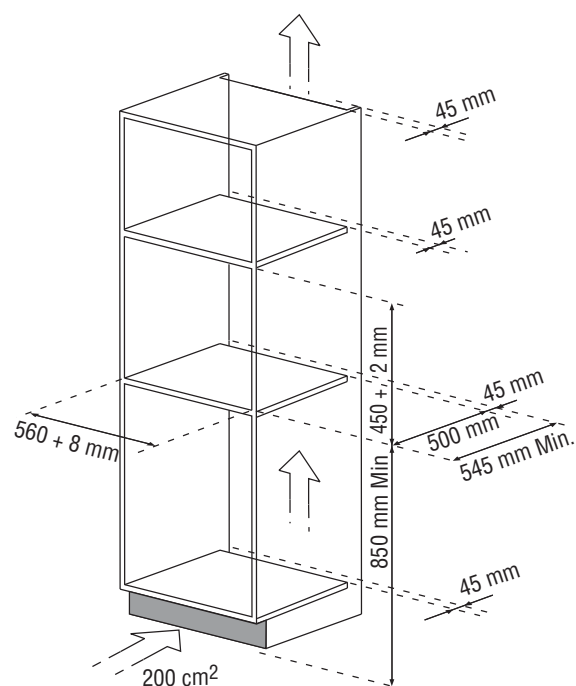
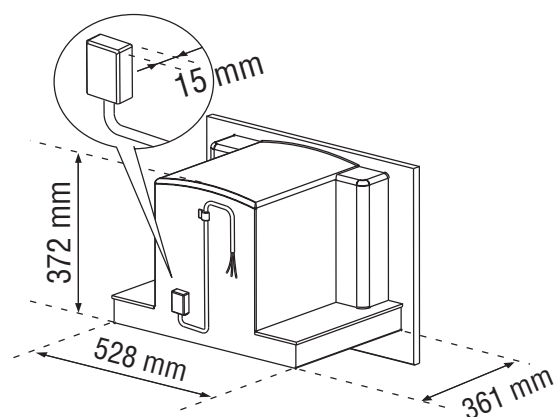
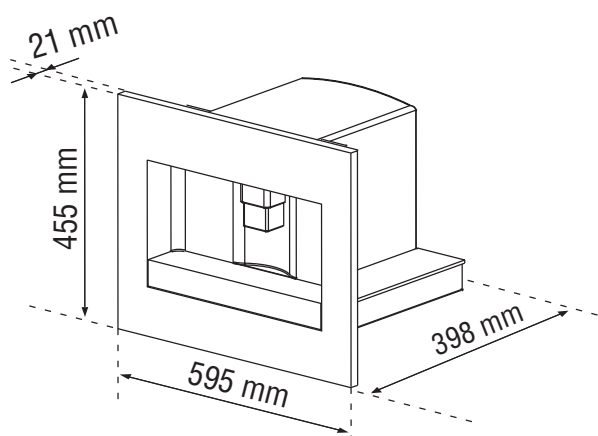

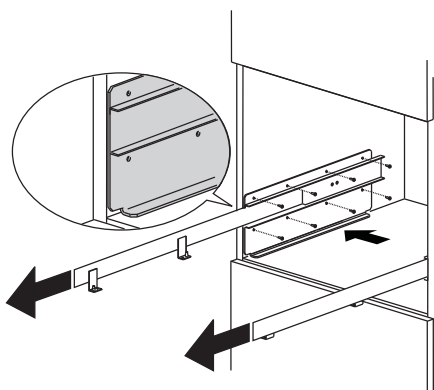

Position the rails on the sides of the cabinet as shown in the figure. Fix with the screws supplied, then extract them completely. If the coffee maker is installed over a warmer drawer, use the top surface of this as a reference to position the rails. In this case, there will be no surface to rest the rails on.

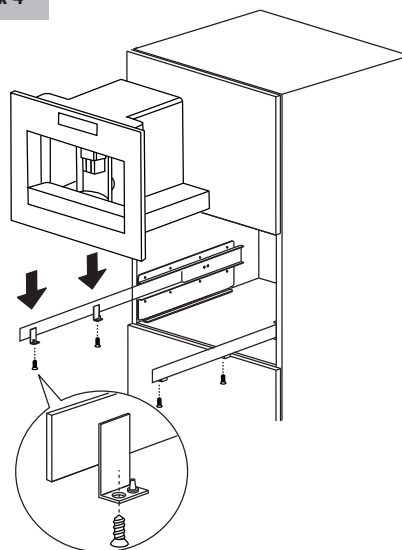

Position the appliance on the rails, making sure the pins are correctly inserted in the housings, then fix it with the screws supplied.

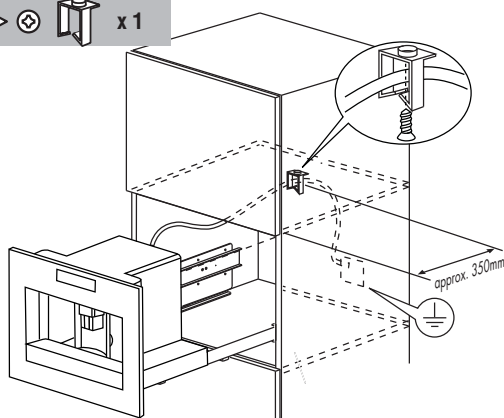

Fix the power cable with the clip. The power cable must be long enough to allow the appliance to be extracted from the cabinet to fill the coffee bean container. **The appliance must be earthed in compliance with legislation. Electrical connections must be performed by a qualified electrician following the instructions.**

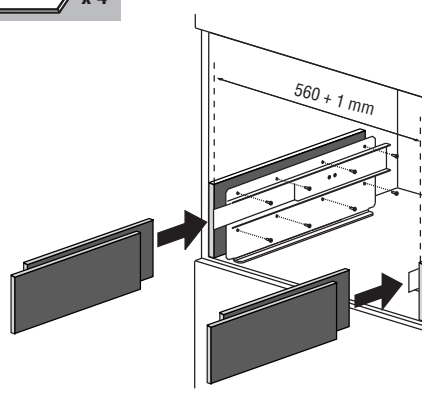

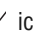

If necessary, correct alignment of the appliance by positioning the spacers supplied under or at the sides of the support.

USING THE APPLIANCE FOR THE FIRST TIME

- Coffee has been used to factory test the appliance and it is therefore completely normal for there to be traces of coffee in the mill.
 - Customise water hardness as soon as possible following the instructions in the "Setting water hardness" section.
1. Connect the appliance to the mains supply.
Set the required language.
 2. To set the language, use the   icons (B7 and B8) to choose the required language (fig. 2).
When "PRESS OK TO INSTALL ENGLISH" is displayed, press the OK icon (B9) (fig. 3).
If you set the wrong language, follow the instructions in the "Setting the language" section.
If your language is not available, select one from those displayed. The instructions refer to the English version.
Then follow the instructions displayed:
 3. After 5 seconds, the appliance displays "FILL TANK!". Extract the water tank (fig. 4), rinse and fill with fresh water without exceeding the MAX line.
Replace and push as far as it will go.
 4. Place a cup under the hot water spout (fig. 5).
The appliance displays: "HOT WATER press OK".
Press the OK icon (B9) (fig. 3) and after a few seconds a little water comes out of the spout.
 5. The machine now displays "TURNING OFF... PLEASE WAIT" and goes off.
 6. Extract the appliance by pulling it out using the handles (fig. 6).
Open the lid and fill the container with coffee beans, then close the lid and push the appliance in.

The coffee maker is now ready for normal use.

 **Important!** Never introduce pre-ground coffee, freeze dried coffee, caramelised beans or anything else which could damage the appliance.

 **N.B.:** When using the appliance for the first time, you need to make 4-5 cups of coffee and 4-5 cappuccinos before the appliance gives satisfactory results.

 **N.B.:** Each time you turn the coffee maker on by the ON/OFF switch (A23), it performs a SELF-DIAGNOSIS cycle and then goes off. To turn it on again, press the ON/OFF button (A7) (fig. 1)

TURNING ON AND HEATING UP



Each time the appliance is turned on, it performs an automatic pre-heat and rinse cycle which cannot be interrupted.

The appliance is ready for use only after completion of this cycle.

 **Danger of burns!** During rinsing, a little hot water flows from the coffee spouts.

To turn the appliance on, press the ON/OFF/stand-by button (A7) (fig. 1). The message "HEATING UP PLEASE WAIT" is displayed.
When heating is complete, the message changes to "RINSING";
The appliance is at temperature when the message "MEDIUM CUP standard taste" is displayed.

MAKING COFFEE USING COFFEE BEANS

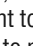
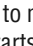
1. The appliance is preset to make coffee with a normal taste.
You can also choose coffee with an extra-mild, mild, standard, strong or extra-strong taste. There is also a pre-ground coffee option.
To choose the required taste, press the  icon (B4) a number of times (fig. 7). The required coffee taste is displayed.
2. Place 1 cup under the spouts to make 1 coffee (fig. 9) or 2 cups for 2 coffees (fig. 8).
Lower the spouts as near as possible to the cup for a creamier coffee (fig. 10).
3. Press the  icon (B5) (fig. 11) to select the type of coffee: espresso, small cup, medium cup, large cup, mug.
Press the  icon (B10) (fig. 12) if you want to make a coffee and the  icon (B11) (fig. 13) if you want to make 2 coffees.
The appliance now grinds the beans and starts delivering the coffee into the cup.
Once the set amount of coffee has been delivered, the machine stops delivery automatically and expels the exhausted waste coffee into the grounds container.
4. After a few seconds, the appliance is ready for use again.
5. To turn the appliance off, press the ON/OFF/stand-by button (A7) (fig. 1).
(Before going off, the appliance performs an automatic rinse cycle. Take care to avoid scalds).

NOTE 1: If the coffee is delivered a drop at a time or not at all, see the "Adjusting the coffee mill" section.

NOTE 2: If the coffee is delivered too fast and the cream is not satisfactory, see the "Adjusting the coffee mill" section.

NOTE 3: Tips for a hotter coffee:

- Proceed as described in the section "Changing and setting menu parameters", "Rinse" function.
- Unless preheated, do not use excessively thick cups as they will absorb too much heat.
- Preheat the cups by rinsing them with hot water.

NOTE 4: Coffee delivery can be interrupted at any moment by re-pressing the previously selected icon.

NOTE 5: As soon as delivery is finished, to increase the quantity of coffee in the cup, just keep pressing the previously selected icon within 3 seconds after delivery has finished.

NOTE 6: When the appliance displays "FILL TANK!", fill the tank with water or the appliance will not deliver coffee.

(It is normal for there to be a little water left in the tank).

NOTE 7: After about 14 single (or 7 double) coffees, the appliance displays "EMPTY GROUNDS CONTAINER!".

To clean, open the service door on the front of the appliance by pulling the spout (fig. 16), extract the drip tray (fig. 17) and clean.

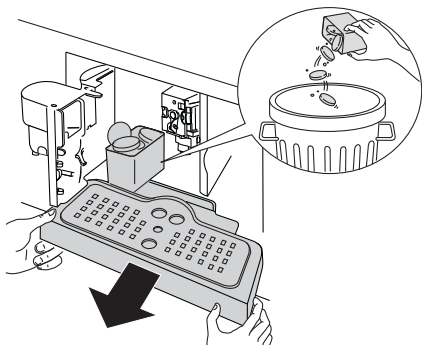

When cleaning, **always extract the drip tray completely.**

Important! When extracting the drip tray, the grounds container **MUST** always be emptied. If this is not done, the machine may be clogged.

NOTE 8: Never extract the water tank while the machine is delivering coffee.

If it is removed, it will not be possible to make the coffee and the appliance will display "GROUND TOO FINE ADJUST MILL ! PRESS OK" and then "FILL TANK!". Check the level of water in the tank and replace in the appliance.

To turn the appliance back on, insert the water spout if not already in place (fig. 6), then press the OK icon (B9). "HOT WATER PRESS OK" is displayed.

Press the OK icon (B9) within a few seconds and deliver water from the spout for about 30 seconds. When delivery stops, the basic modes are displayed again.

N.B.: The coffee maker may request the operation to be repeated a number of times until the air is completely eliminated from the hydraulic circuit.

N.B.: if this operation is not performed correctly or if the machine is turned off, the basic modes may be displayed, although the problem is in fact still present.

CHANGING THE QUANTITY OF COFFEE IN THE CUP

The appliance is set by default to automatically make the following amounts of coffee:

- espresso
- small cup
- medium cup
- large cup
- mug

To change and memorise the amount of coffee required, for example when making an espresso, proceed as follows:

- Press the ☞ icon (B5) until "ESPRESSO" is displayed.
- Press and hold the ☞ icon (B10) until "PROGRAM QUANTITY ESPRESSO" is displayed.

At the same time, the appliance delivers coffee.

- Press the ☞ icon (B10) again or the OK icon to stop delivery and memorise the new quantity of coffee.

The appliance is now reprogrammed with the new setting and is ready for use.

You can change the amount of coffee in the small cup, medium cup, large cup and mug.

N.B.: When the ☞ icon (B11) is pressed, double the amount of coffee set previously with the ☞ icon (B10) is delivered.

To reset the original settings, see "Resetting default values".

ADJUSTING THE COFFEE MILL

The coffee mill is preset in the factory and should not require adjusting. However, if after making the first few coffees you find that delivery is either too fast or too slow (a drop at a time), this can be corrected by adjusting the grinding adjustment knob (fig. 14).

Important! The grinding adjustment knob must only be turned when the coffee mill is in operation.

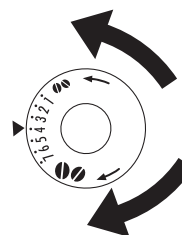

For slower delivery and creamier coffee, turn one click anticlockwise (finer pre-ground coffee).

For faster delivery (not a drop at a time), turn one click clockwise (coarser pre-ground coffee).

MAKING ESPRESSO COFFEE WITH PRE-GROUND COFFEE (INSTEAD OF BEANS)

- Press the ☞ icon (B4) (fig. 7) and select the pre-ground coffee function.
- Extract the machine by pulling it outwards using the handles (fig. 6).
- Lift the central lid, place one measure of pre-ground coffee in the funnel (fig. 19), push the appliance in then proceed as described in the section "Making coffee using coffee beans".
N.B.: You can make just one coffee at a time by pressing the ☞ icon (B10) (fig. 12).
- After using the machine with pre-ground coffee, to go back to making coffee using beans, deactivate the pre-ground coffee function by pressing the ☞ icon (B4) (fig. 7).

NOTE 1: Never introduce pre-ground coffee when the machine is off or it could spread through the inside of the appliance.

NOTE 2: Never add more than 1 measure, otherwise the appliance will not make the coffee.



NOTE 3: Use the measure provided only.

NOTE 4: Introduce only pre-ground coffee for espresso coffee machines into the funnel.

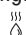

NOTE 5: If more than one measure of pre-ground coffee is used and the funnel clogs, push the coffee down with a knife (fig. 21) then remove and clean the brewing unit and machine as described in the "Cleaning the brewing unit" section.

DELIVERING HOT WATER

- Always make sure the appliance is ready.

- Turn the cappuccino maker outwards and place a container underneath (fig. 5).
- Press the  icon (B6) (fig. 20).
The appliance displays: "HOT WATER PRESS OK". Press the OK icon (B9) again and hot water is delivered from the cappuccino maker into the container below.
You should not deliver hot water for more than 2 minutes at a time.
To interrupt, press the  icon (B6) or the OK icon (B2).
The appliance stops delivery once the set quantity is reached.

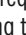
MAKING CAPPUCCINO (USING THE STEAM FUNCTION)

- Turn the cappuccino maker towards the centre (fig. 5).
- Take a container, fill it with about 100 g of milk for each cappuccino to be made and place it under the cappuccino maker. In choosing the size of the recipient, bear in mind that the milk doubles or triples in volume. You are recommended to use partially skimmed milk at refrigerator temperature.
- Press the  icon (B12) (fig. 22). "STEAM PRESS OK" is displayed.
- Press the OK icon (B9).
- Immerse the cappuccino maker in the milk container (fig. 23), taking care not to immerse it for more than half its length.
Steam comes out of the cappuccino maker.
For a creamier froth, immerse the cappuccino maker in the milk and move the container with slow upward movements.
You should not deliver steam for more than 2 minutes at a time.
- When the required temperature is reached, interrupt steam delivery by pressing the  icon (B12) again or the OK icon (B2).
- Make the coffee as described above using sufficiently large cups, then fill them with the frothed milk prepared previously.
IMPORTANT: always clean the cappuccino system immediately after use.
Proceed as follows:
 - Press the  icon (B12) and then press the OK button (B9) to discharge a small amount of steam for a few seconds.
This empties the steam spout of all traces of milk.
IMPORTANT: to ensure the hygiene of the appliance, you are recommended to carry out this procedure each time you make cappuccino to avoid stale milk remaining in the circuit.
 - Wait for the cappuccino maker to cool down, then holding the cappuccino maker lever firmly in one hand, unscrew the cappuccino maker itself with the other, turning it anticlockwise and removing it downwards (fig. 24).
 - Remove the cappuccino maker nozzle by pulling it downwards.
 - Wash the cappuccino maker and nozzle thoroughly in hot water.
 - Make sure the two holes shown in figure 25 are not blocked.
If necessary, clean with a pin.
 - Replace the nozzle by inserting it upwards into the cappuccino maker.
 - Replace the cappuccino maker by pushing it upwards and rotating it clockwise.

CLEANING

Cleaning the coffee maker

Do not use solvents or abrasive detergents to clean the coffee maker. A soft damp cloth will suffice.

Never wash any of the components of the coffee maker in the dishwasher.

The following parts of the machine must be cleaned regularly:

- Grounds container (A4).
- Drip tray (A14).
- Water tank (A12).
- Coffee spouts (A13).
- Pre-ground coffee funnel (A21).
- Inside of the machine, accessible after opening the service door (A2).
- Brewing unit (A5).

Cleaning the grounds container

When "EMPTY GROUNDS CONTAINER!" is displayed, the grounds container must be emptied and cleaned.

To clean:

- open the service door on the front of the appliance (fig. 16), extract the drip tray (fig. 17) and clean.
- Clean the grounds container thoroughly.

 **Important!** When extracting the drip tray, the grounds container **must** always be emptied.

Cleaning the drip tray

 **Important!** If the drip tray is not emptied the water might overflow. This could damage the machine.

The drip tray is fitted with a level indicator (red) showing the level of water it contains (fig. 27).

Before the indicator protrudes from the cup tray, the drip tray must be emptied and cleaned.

To remove the tray:

1. Open the service door (fig. 16).
2. Remove the drip tray and the grounds container (fig. 17).
3. Clean the drip tray and grounds container (A4).
4. Replace the drip tray and grounds container (A4).
5. Close the service door.

Cleaning the water tank

1. Clean the water tank (A12) regularly (about once a month) with a damp cloth and a little mild washing up liquid.
2. Remove all traces of washing up liquid.

Cleaning the spouts

1. Clean the nozzles periodically using a sponge (fig. 28).
2. Check regularly that the holes in the coffee spout are not blocked.
If necessary, remove coffee deposits with a toothpick (fig. 26).

Cleaning the pre-ground coffee funnel

- Check regularly (about once a month) that the pre-ground coffee

fee funnel is not blocked (fig. 21).



Danger! Before performing any cleaning operations, the machine must be turned off by pressing the main switch (A23) and unplugged from the mains power supply. Never immerse the coffee maker in water.

Cleaning the inside of the coffee maker

1. Check regularly (about once a week) that the inside of the appliance is not dirty.
If necessary, remove coffee deposits with a sponge.
2. Remove the residues with a vacuum cleaner (fig. 29).

Cleaning the brewing unit

The brewing unit must be cleaned at least once a month.



Important! The brewing unit (A5) must not be removed when the appliance is on. Do not use force to remove the brewing unit.

1. Make sure the machine is correctly turned off (see "Turning the appliance off").
2. Open the service door (fig. 16).
3. Remove the drip tray and grounds container (fig. 17);
4. Press the two red release buttons inwards and at the same time pull the brewing unit outwards (fig. 30).



Important! Do not use washing up liquid to clean the brewing unit. It would remove the lubricant applied to the inside of the piston.

5. Soak the brewing unit in water for about 5 minutes, then rinse.
6. After cleaning, replace the brewing unit (A5) by sliding it onto the internal support and pin at the bottom,

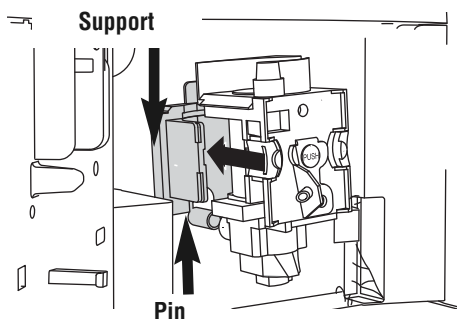

then push the PUSH symbol fully in until it clicks into place.



N.B.! If the brewing unit is difficult to insert, you must first adapt it to the right dimensions by pressing it forcefully from the bottom and top as shown in the figure.

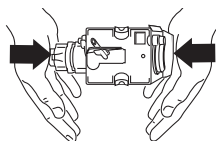

7. Once inserted, make sure the two red buttons have snapped out.

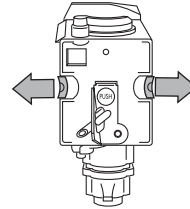

8. Replace the drip tray and grounds container.
9. Close the service door.

CHANGING AND SETTING MENU PARAMETERS

When the appliance is ready, you can use the internal menu to modify the following parameters and functions:

- RINSING
- ADJUST TIME
- LANGUAGE
- AUTO-START
- DESCALE
- COFFEE TEMPERATURE
- AUTO-OFF
- WATER HARDNESS
- RESET TO DEFAULT
- STATISTICS
- SET BEEP
- EXIT

Rinsing

This function enables you to obtain hotter coffee.

Proceed as follows:



- When you turn the appliance on, if you want to make a small cup of coffee (less than 60 cc), preheat the cup by rinsing it with hot water.
- If on the other hand more than 2/3 minutes have passed since the last coffee was made, before requesting another coffee, you must preheat the infuser by first pressing the MENU icon (B2) to enter the menu. "RINSING" is displayed.
Press the OK icon (B9).
"OK to confirm" is displayed.
Press the OK icon (B9) again.
Deliver the water into the underlying drip tray or alternatively use this water to fill (and then empty) the cup to be used for the coffee to preheat it.

Setting the clock

- Press the MENU icon (B2) to enter the menu and then the icons (B7) and (B8) until "ADJUST TIME" is displayed.
- Press the OK icon (B9).
- Use the ^ v icons (B7) and (B8) to set the hour, then press the OK icon (B9) to confirm.
- Use the ^ v icons (B7) and (B8) to set the minutes, then press the OK icon (B9) to confirm.
- Press the MENU icon (B2) to exit the menu.





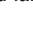

Setting the language

To change the language on the display, proceed as follows:

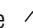
- Press the MENU icon (B2) to enter the menu, then the   icons (B7) and (B8) to select the "LANGUAGE" function.
- Press the OK icon (B9).
- Press the   icons (B7) and (B8) until the required language is displayed.
- Press the OK icon (B9) to confirm.
- Press the MENU icon (B2) to exit the menu.

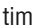
Setting auto-start time

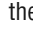
This function programmes the time the machine will come on automatically.

- Make sure the clock on the appliance has been set.
 - Press the MENU icon (B2) to enter the menu and then the   icons (B7) and (B8) until "AUTO-START" Deactivated" is displayed.
 - Press the OK icon (B9).
 - "AUTO-START Activate?" is displayed.
 - Press the OK icon (B9) to confirm.
 - "AUTO-START 07:30" is displayed.
 - Use the   icons (B7) and (B8) to set the auto-start time, then press the OK icon (B9) to confirm.
 - Use the   icons (B7) and (B8) to set the minutes, then press the OK icon (B9) to confirm.
 - Press the OK icon (B9). "AUTO-START Activated" is displayed.
 - Press the MENU icon (B2) to exit the menu.
- The  symbol appears on the display near the time.

Descaling





Important! Descaler contains acids. Respect the safety warnings provided by the manufacturer and given on the descaler pack.



N.B.! Use the descaler recommended by the manufacturer only. Use of other descalers invalidates the guarantee. Failure to descale the appliance as described also invalidates the guarantee.

When "DESCALE !" is displayed, the machine requires descaling.

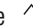
Proceed as follows:

- make sure the machine is ready;
- attach the hot water spout (C7) to the nozzle (A10).
- Press the MENU icon (B2) to enter the menu and then the   icons (B7) and (B8) until "DESCALING" is displayed.
- Press the OK icon (B9) and the appliance displays "DESCALING OK to confirm".
- Press the OK icon (B9).
- "ADD DESCALER press OK" is displayed.
- Empty the tank of water, pour the contents of the descaler bottle into the tank respecting the instructions given on the descaler pack, then add water up to the MAX level marked on the water tank.
- Position a container with a capacity of about 2 litres under the hot water spout.
- Press the OK icon (B9). Descaler flows out of the hot water spout into the container below.
- "DESCALING..." is displayed.
- The descale programme automatically performs a series of de-

liveries and pauses.



- After about 30 minutes "RINSING FILL TANK!" is displayed.
 - Empty the water tank, rinse to eliminate descaler residues, then fill with clean water.
 - Replace the tank full of clean water.
 - "RINSING press OK" is displayed.
 - Press the OK icon (B9) again.
 - Hot water flows out of the spout into the container below and "RINSING PLEASE WAIT" is displayed.
 - Wait until "RINSING COMPLETE press OK" is displayed.
 - Press the OK icon (B9).
 - "DESCALING COMPLETE" is displayed, followed by "FILL TANK!".
 - Fill the tank again with clean water.
 - The descale programme is now terminated and the appliance is ready to make coffee again.
- NOTE: If descaling is interrupted before completion, the process must be begun again from the beginning.



Important! FAILURE TO DESCALE THE APPLIANCE REGULARLY INVALIDATES THE GUARANTEE.

Changing coffee temperature

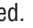
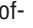

To change coffee temperature, proceed as follows:

- Press the MENU icon (B2) to enter the menu and then the   icons (B7) and (B8) until "COFFEE TEMPERATURE" is displayed.
- Press the OK icon (B9).
- Press the   icons (B7) and (B8) to select the required coffee temperature from low, medium and high.
- Press the OK icon (B9) to confirm the temperature selected.
- Press the MENU icon (B2) to exit the menu.

Changing the length of time the appliance remains on

The appliance is set by default to go off automatically 30 minutes after the last coffee has been made.

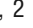

To change this interval (max. 120 min), proceed as follows:

- Press the MENU icon (B2) to enter the menu and then the   icons (B7) and (B8) until "AUTO-OFF" is displayed.
- Press the OK icon (B9) to confirm.
- Press the   icons (B7) and (B8) to set the time after which the appliance will go off (after 30 minutes, 1 hour, 2 hours).
- Press the OK icon (B9) to confirm.
- Press the MENU icon (B2) to exit.

Setting water hardness

The operating period can be extended if required, making descaling less frequent by programming the machine on the basis of the real lime content in the water used.

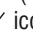

Proceed as follows:

- remove the "Total Hardness Test" strip (attached to page 2) from its packaging then dip it fully in the water for a few seconds, Then remove and wait about 30 seconds (until it changes colour and forms red squares).
- Press the MENU icon (B2) to enter the menu and then the   icons (B7) and (B8) until "WATER HARDNESS" is displayed.

- Press the OK icon (B9).
- Press the   icons (B7) and (B8) until the number of spots coincides with the number of red squares on the test strip (for example, if there are 3 red squares on the test strip, select “●●●○”);
- Press the OK icon (B9) to confirm.
The coffee maker is now programmed to provide the descale warning when actually necessary.
- Press the MENU icon (B2) to exit.

Resetting default values (reset)





If you change the original values, the default values can be reset as follows:

- Press the MENU icon (B2) to enter the menu and then the   icons (B7) and (B8) until "DEFAULT VALUES" is displayed.
- Press the OK icon (B9). "OK to confirm" is displayed.
- Press the OK icon (B9) to reset the default values; "RESET" is displayed for a few seconds.
- Press the MENU icon (B2) to exit the menu.

Statistics

This displays statistics relating to the machine.

To display, proceed as follows:



- Press the MENU icon (B2) to enter the menu and then the   icons (B7) and (B8) until "STATISTICS" is displayed.
- Press the OK icon (B9).
- Press the   icons (B7) and (B8) to verify:
 - How many coffees and cappuccinos have been made.
 - How many times the machine has been descaled.
 - The total number of litres of water delivered.
- Press the MENU icon (B2) once to exit the function or twice to exit the menu.

Set beep

This activates or deactivates the beep emitted by the machine each time an icon is pressed or an accessory is inserted/removed.



N.B.! The beep is active by default.

- Press the MENU icon (B2) to enter the menu and then the   icons (B7) and (B8) until "BEEP Activated" is displayed.
- Press the OK icon (B9). "BEEP Deactivate?" is displayed.
- Press the OK icon (B9) to deactivate the beep.
- Press the MENU icon (B2) to exit the menu.

TURNING THE APPLIANCE OFF

Each time the appliance is turned off, it performs an automatic rinse cycle which cannot be interrupted.



Danger of burns! During rinsing, a little hot water flows from the coffee spouts. Avoid contact with splashes of water.
To turn the appliance off, press the ON/OFF button (A7).
The appliance performs the rinse cycle then goes off.



N.B.! If the appliance is not used for an extended period, place the main switch on the side of the appliance in the **0** position (A23).

TECHNICAL SPECIFICATION

Voltage: 220-240 V~ 50/60 Hz max. 10A

Absorbed power: 1350 W

Pressure: 15 bars

Water tank capacity: 1.8 litres

Size LxHxD: 595 x 455 x 398 mm

Weight: 26 kg



The appliance complies with the following EC directives:

- Low Voltage Directive 2006/95/EC and subsequent amendments;
- EMC Directive 2004/108/EC and subsequent amendments

Materials and accessories coming into contact with food conform to European regulation (EC) no. 1935/2004.

DISPLAYED MESSAGES

DISPLAYED MESSAGE	POSSIBLE CAUSE	REMEDY
REMEDY	<ul style="list-style-type: none"> The water tank is empty or positioned incorrectly. 	<ul style="list-style-type: none"> Fill the tank with water and/or insert it correctly, pushing it as far as it will go.
GROUND TOO FINE ADJUST MILL! INSERT WATER SPOUT! press OK	<ul style="list-style-type: none"> The grinding is too fine and the coffee is delivered too slowly. 	<ul style="list-style-type: none"> Turn the grinding adjustment knob one click clockwise towards "7".
GROUND TOO FINE ADJUST MILL! (alternating with) press OK (then) FILL TANK !	<ul style="list-style-type: none"> The tank has been removed during delivery. There is air in the hydraulic circuit. 	<ul style="list-style-type: none"> Insert the tank and press the OK icon (B9). "HOT WATER" is displayed. Hot water is delivered and the appliance is once again ready for use.
EMPTY GROUNDS CONTAINER!	<ul style="list-style-type: none"> The grounds container (A4) is too full or more than 3 days have passed since you last made coffee (this guarantees correct hygiene of the machine). 	<ul style="list-style-type: none"> Empty the grounds container and clean, then replace. Important: when removing the drip tray, the grounds container MUST be emptied, even if it is not completely full. If this is not done, when you make the next coffees, the grounds container may fill up more than expected and clog the machine.
INSERT GROUNDS CONTAINER!	<ul style="list-style-type: none"> After cleaning, the grounds container has not been replaced. 	<ul style="list-style-type: none"> Open the service door and insert the grounds container.
ADD PRE-GROUND COFFEE!	<ul style="list-style-type: none"> The "pre-ground coffee" function has been selected without placing any pre-ground coffee in the funnel. The funnel (A21) is blocked. 	<ul style="list-style-type: none"> Extract the appliance and place pre-ground coffee in the funnel. Empty the funnel with the help of a knife as described in the section "Cleaning the pre-ground coffee funnel".
DESCALE! (alternating with) MEDIUM CUP STANDARD TASTE	<ul style="list-style-type: none"> The machine must be descaled. 	<ul style="list-style-type: none"> The descaling procedure described in the "Descaling" section needs to be performed as soon as possible.
LESS COFFEE !	<ul style="list-style-type: none"> Too much coffee has been used. 	<ul style="list-style-type: none"> Select a milder taste or reduce the quantity of pre-ground coffee, then make the coffee again.
FILL BEANS CONTAINER!	<ul style="list-style-type: none"> The coffee beans have run out. 	<ul style="list-style-type: none"> Fill bean container
INSERT INFUSER ASSEMBLY!	<ul style="list-style-type: none"> The brewing unit has not been replaced after cleaning. 	<ul style="list-style-type: none"> Insert the brewing unit as described in the section "Cleaning the brewing unit".
CLOSE DOOR !	<ul style="list-style-type: none"> The service door is open. 	<ul style="list-style-type: none"> Close the service door.
GENERAL ALARM!	<ul style="list-style-type: none"> The inside of the appliance is very dirty. 	<ul style="list-style-type: none"> Clean the inside of the appliance thoroughly, as described in the section "Cleaning and maintenance". If the message is still displayed after cleaning, contact a customer services.

TROUBLESHOOTING

Below is a list of some of the possible malfunctions.

If the problem cannot be resolved as described, contact Customer Services.

PROBLEM	POSSIBLE CAUSE	REMEDY
The coffee is not hot	<ul style="list-style-type: none"> The cups were not preheated. The brewing unit has cooled down because 2/3 minutes have elapsed since the last coffee was made. The temperature set is too low. 	<ul style="list-style-type: none"> Warm the cups by rinsing them with hot water. Before making coffee, preheat the brewing unit by selecting the RINSING function in the menu. Change the set temperature (see paragraph "Changing coffee temperature").
The coffee is not creamy enough	<ul style="list-style-type: none"> The coffee is ground too coarsely. Wrong type of coffee 	<ul style="list-style-type: none"> Turn the grinding adjustment knob one click anticlockwise towards "1" while the coffee mill is in operation (fig. 14). Use a type of coffee for espresso coffee makers.
The coffee is delivered too slowly or a drop at a time.	<ul style="list-style-type: none"> The coffee is ground too finely. 	<ul style="list-style-type: none"> Turn the grinding adjustment knob one click clockwise towards "7" while the coffee mill is in operation (fig. 14). Continue one click at a time until coffee delivery is satisfactory. The effect is only visible after delivering two coffees.
The coffee is delivered too quickly.	<ul style="list-style-type: none"> The coffee is ground too coarsely. 	<ul style="list-style-type: none"> Turn the grinding adjustment knob one click anticlockwise towards "1" while the coffee mill is in operation (fig. 14). Avoid turning the grinding adjustment knob excessively otherwise when you select 2 cups, the coffee may be delivered a drop at a time. The effect is only visible after delivering two coffees.
Coffee does not come out of one of the spouts.	<ul style="list-style-type: none"> The spouts are blocked. 	<ul style="list-style-type: none"> Clean the spouts with a toothpick (fig. 26).
The coffee does not come out of the spouts, but from around the service door (A2).	<ul style="list-style-type: none"> The holes in the spouts are clogged with dry coffee dust. The coffee guide (A3) inside the service door is blocked and cannot swing. 	<ul style="list-style-type: none"> If necessary, remove coffee deposits with a toothpick, sponge or stiff bristled kitchen brush (fig. 26-28). Thoroughly clean the coffee guide (A3), particularly near the hinges.
Water comes out of the spouts instead of coffee.	<ul style="list-style-type: none"> The pre-ground coffee may be blocked in the funnel (A21). 	<ul style="list-style-type: none"> Clean the funnel (A21) with a wooden or plastic fork, clean the inside of the machine.

