

INSTALLING THE ALTERNATIVE 40mm FASCIA PANEL:
Ariston 600 / 900 Slide-out Range Hood – ARHS 60X-L / ARH9SIX-L

This document is a quick guide on how to replace the fascia panel (front rail) of your slide-out range hood. This range hood model is factory fitted with an 80mm front rail that is suitable for both recirculating and ducted installations. However, if the appliance is being installed in ducted mode, there is an option of replacing the standard front rail with the 40mm fascia panel that is also supplied in the product packaging.

Disassembling the bracket that holds the sliding switches provides access to the screws that hold the front rail in position. Please follow the instructions below when replacing the front rails.

2306013.001 – 80mm Fascia Panel (spare part)

2306013.002 – 40mm Fascia Panel (spare part)

2399000.414 – Sliding Switch (spare part)

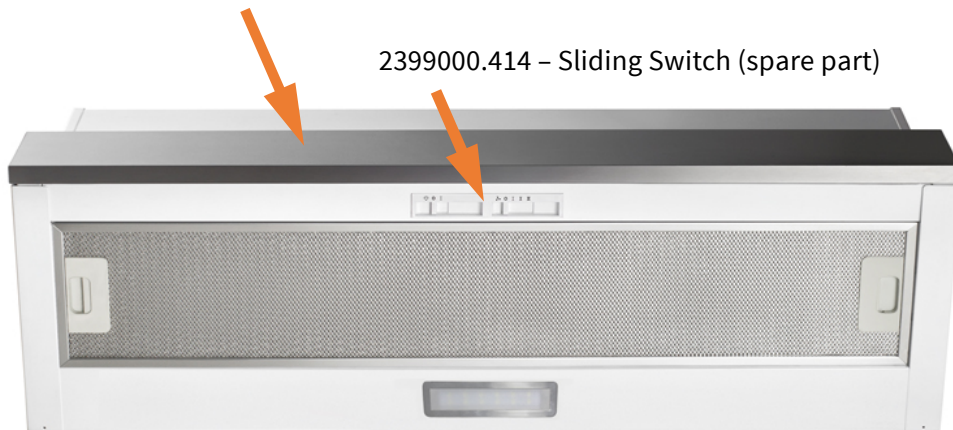

Instructions

1 – Before installing the appliance, slide open the filter drawer and remove both filter panels.

NOTE: remove the protective blue film from parts once the installation is completed.

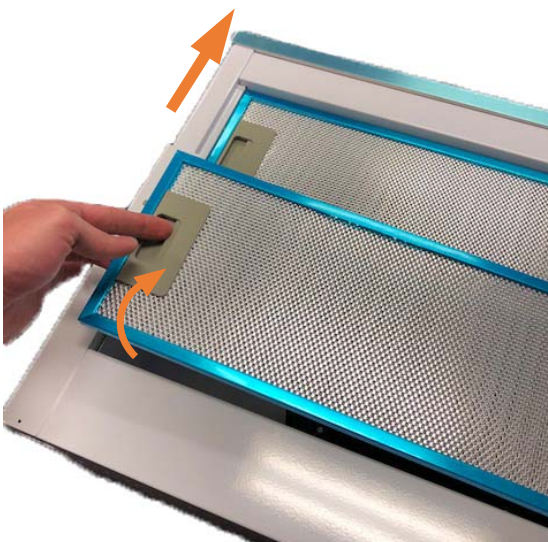

2 – Remove all 4 screws that hold the sliding switch bracket in position. Two on each side of the filter drawer (top and bottom).





3 – Remove the sliding switch bracket. Please note that a cord will still be attached to the bracket.



4 – Remove all 4 screws that hold the front rail in position.



5 – Slightly twist and slide the front rail to unhook it from the drawer tab.

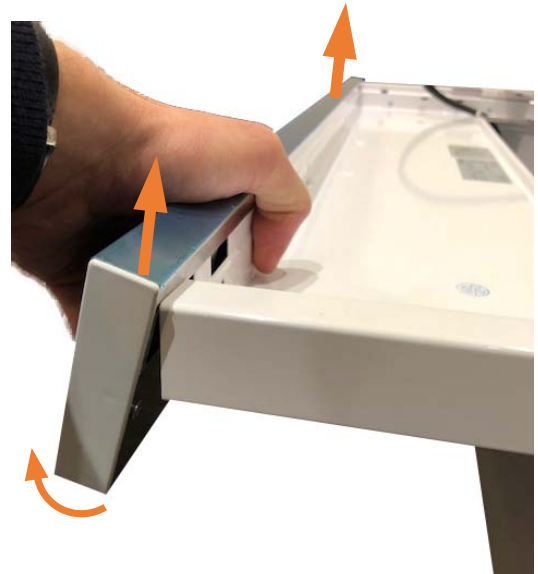

6 – Reverse the previous step to hook the 40mm front rail in place.

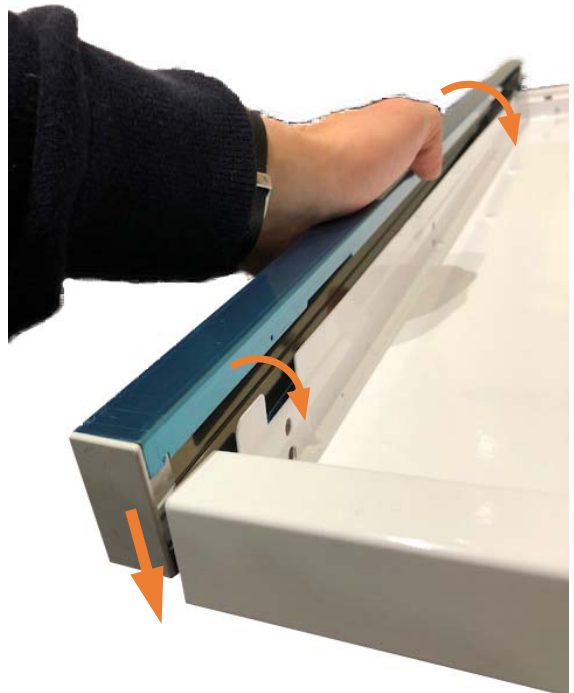

7 – Close the drawer and ensure that the front rail is centred and square.

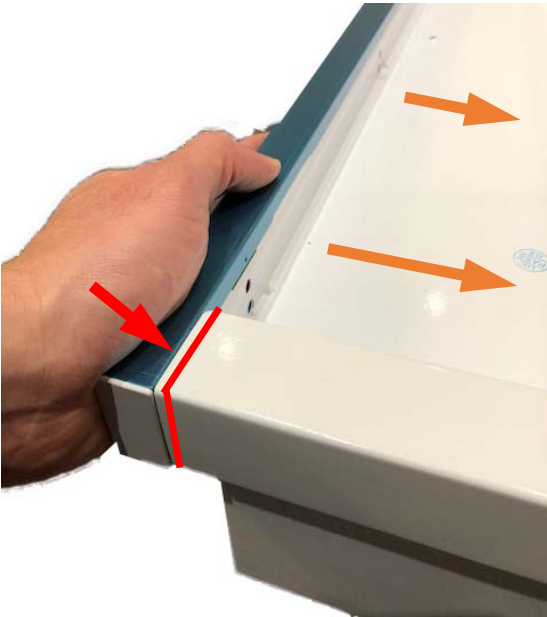

8 – Screw the front rail in place. (Step 4 in reverse).

9 – Replace the sliding switch bracket in position making sure that the cable is aligned with the cut-out on the bracket.



10 – Screw the bracket in place. (Step 2 in reverse).

11 – Proceed with the installation of the range hood. Once completed, remove the protective film from the filter panels and replace them on the unit.

If you require any further assistance, please contact us.

Arisit Customer Care
consumer.care@arisit.com
1300 762 219